

# PRODUCT ID: 64790

## Space Available Sign

**MODEL**  
S-SA6541WGR-Q723/120-277VAC



**DIMENSIONS**  
65" H x 41" W x 5.5" D (est. 120.702 lbs)

**CLASS**  
**Class:** SA Series Smart Sign  
**Control Method:** RedStorm Sign Control and Reporting Software Comms (by others): PC or Windows server, Ethernet and static lease required

**CONSTRUCTION**  
**Back Construction:** 0.125" Aluminum sheet  
**Cabinet:** Corrosion resistant, extruded aluminum frame with a hinged face. 5.5" deep, mitered construction. LED displays are attached using sign-in-sign construction. Moisture absorbent interior coating.  
**Face Material:** 1/8" thick routed aluminum panel.  
**Faces:** Single Faced Sign  
**Finish:** Other (Blue TBD)  
**Graphic:** Printed graphic applied to surface  
**Number of Displays:** (4)

**ELECTRICAL**  
**Input Voltage:** 120-277 VAC  
**UL/cUL Listed:** Listed for wet locations

**MESSAGE**  
**Color:** Refer to message table (Printed Blue TBD Translucent, printed white)  
**Display Type:** 926 Green 7-Seg | Red FULL Display  
**Font:** Swiss 721 Bold BT  
**Sign Messages:** See message table below

MESSAGE	LED/COLOR	HEIGHT	AMPS
4-digit Seven Segment w/ FULL	Green, Red	7.5", 6.0"	0.315-0.136
4-digit Seven Segment w/ FULL	Green, Red	7.5", 6.0"	0.315-0.136
4-digit Seven Segment w/ FULL	Green, Red	7.5", 6.0"	0.315-0.136
4-digit Seven Segment w/ FULL	Green, Red	7.5", 6.0"	0.315-0.136

NOTE: Above messages are independently controlled.

# Product View

NOTE: Sign image may not exactly represent the finished product. For illustration purposes only.

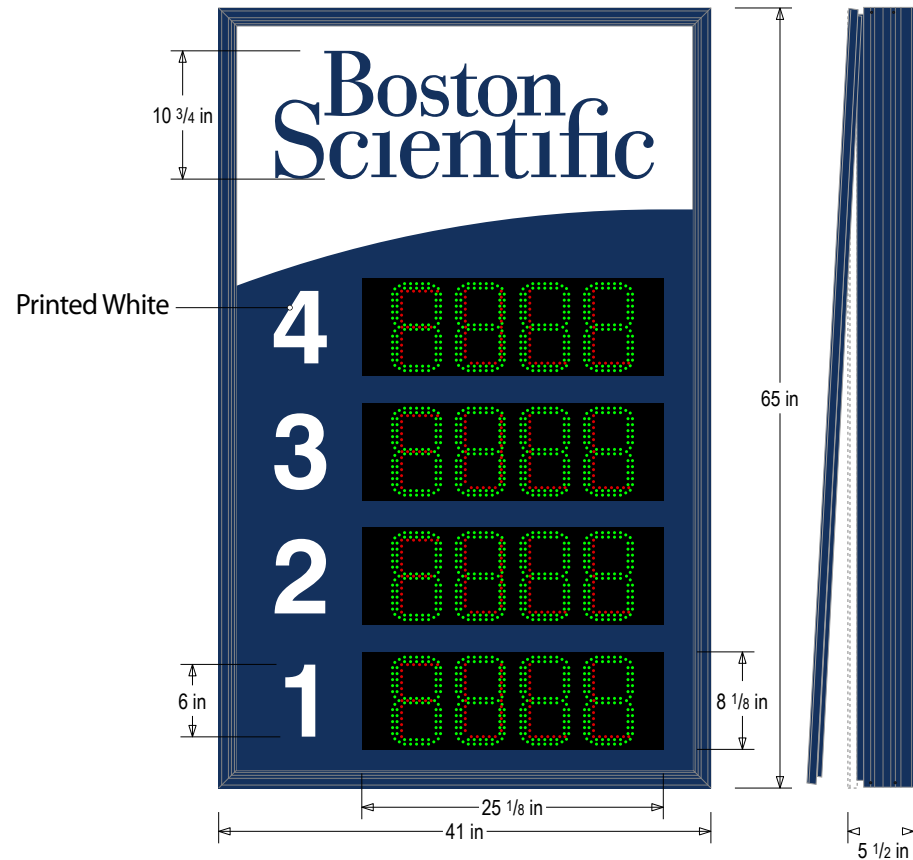

Prod. ID 50912  
Seven Segment  
Display Functions



FULL



Frame Detail

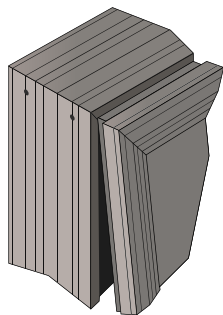

Color Key:



Printed White



Painted TBD Blue