

RLK12-500WB4

5MP 12CH Dual-Band Wi-Fi Surveillance System, 12-Channel NVR with 1TB HDD, 4pcs of 5MP Cameras, Intelligent Detection, 24/7 Recording, IP67 Weatherproof Rating, and More.

- 5MP HD with Dual-Band WiFi
- Person/Vehicle/Animal Detection
- 12-Channel NVR Recorder with 1TB HDD



Specifications

Video & Audio	
Image Sensor	1/2.7" CMOS Sensor
Resolution	2560 x 1920 (5 megapixels) @20fps
Lens	f=4.0 mm fixed; F=2.0, with IR Cut
Video Compression	H.264/H.265
Field of View	Horizontal: 80°; Diagonal: 100°; Vertical: 42°
Day/Night Mode	Auto-switching
Night Vision	Up to 30 meters (100ft) ; LED: 18 pcs/ 14mil/850nm
Frame Rate	Main stream: 2fps–20fps (Standard: 20fps); Sub stream: 4fps–15fps (Standard: 10fps)
Code Rate	Main stream: 1024Kbps–5120Kbps (Standard: 3072Kbps); Sub stream: 64Kbps–512Kbps (Standard: 256Kbps)

Audio	Audio recording
Power Requirements	
DC Power	DC 12.0V 1A, <12W
Interface	
Power Port	DC power port
Reset Button	YES
Ethernet Port	One 10M/100Mbps; RJ45
Storage	Reolink NVR
Audio In/Out	Built-in microphone
Wi-Fi	
Wireless Standard	IEEE 802.11a/b/g/n
Operating Frequency	2.4GHz/5GHz
Wireless Security	WPA-PSK/WPA2-PSK
Software	
Browsers Supported	Edge, Chrome, Firefox, Safari
OS Supported	PC: Windows, Mac OS; Smartphone: iOS, Android
Protocols & Standards	SSL, TCP/IP, UDP, UPNP, NTP, DHCP, DNS, DDNS
User Access	Max. 20 users (1 admin & 19 users); Max. 12 simultaneous streams (2 main & 10 sub streams)
Other Feature	
Smart Alarm	Motion detection; person detection; vehicle detection; animal detection
Recording Modes	Motion-triggered recording (default); scheduled recording, 24/7 recording
Working Environment	
Temperature	-10°C – +55°C (14°F – 131°F) C
Humidity	10% – 90%

Weatherproof	IP67
Mechanical	
Dimensions	Φ67 x 186mm
Weight	415g
Warranty	
Limited Warranty	2-year limited warranty. For support, visit https://support.reolink.com/hc/en-us/ .

Gallery & Specs

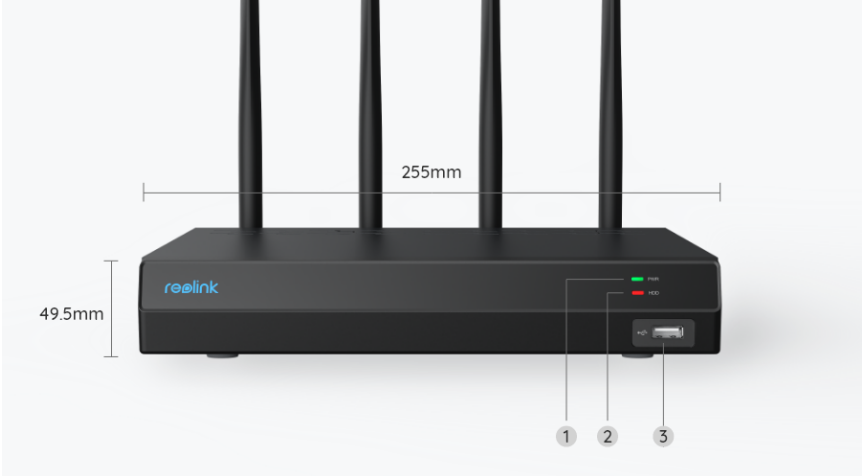

- 1. Power LED
- 2. HDD LED
- 3. USB Port

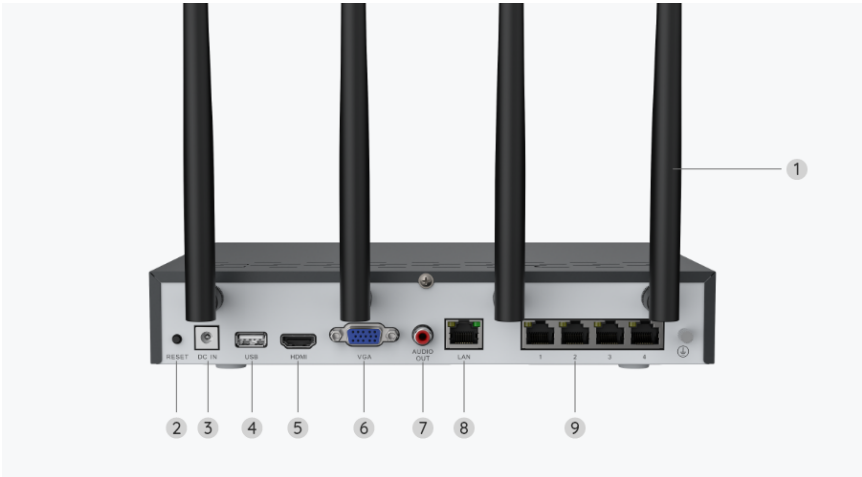

- 1. Antenna
- 2. Reset Button
- 3. Power Input
- 4. USB Port
- 5. HDMI Port
- 6. VGA Port
- 7. Audio Output
- 8. LAN Port (For Internet)
- 9. LAN Port (For IP Cameras)

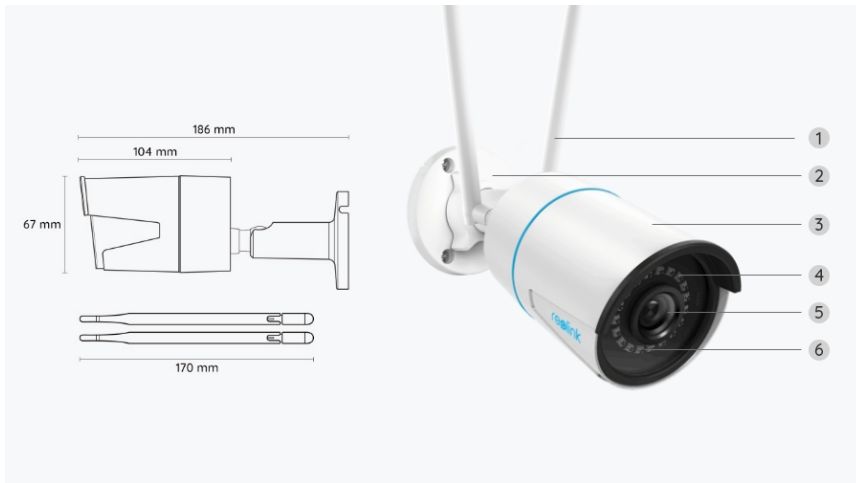

1. Antenna
2. Bracket
3. Metal-Aluminum Housing
4. IR LEDs
5. High-Resolution Lens
6. Daylight Sensor

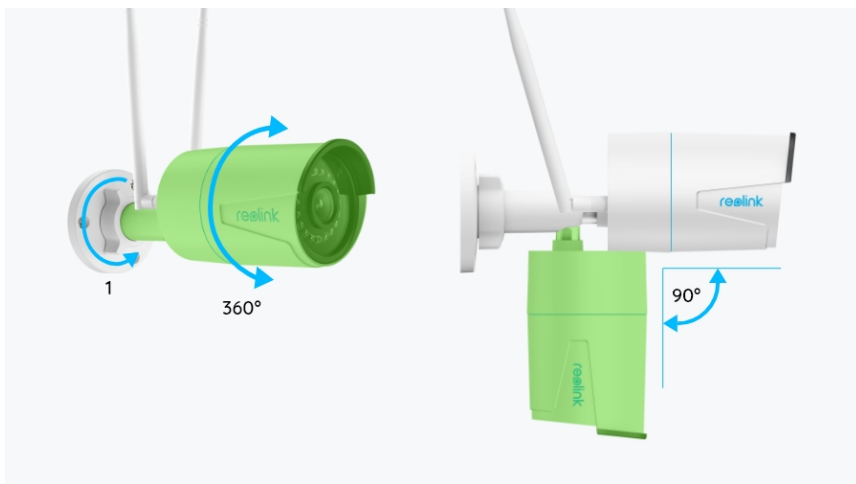

1. Turn the adjustment knob counterclockwise to loosen the bracket and adjust the camera in any direction.
2. After adjustment, rotate the adjustment knob back to secure and fix the camera in place.



1. Power Port
2. Reset Button
3. Network Port