

Drill Press Fence Pro | P/N: 81101371

Drill Press Fence Pro broadly compatible with Drill Press Fence tables, and is quick to attach and adjust because of our proprietary switchable magnets. A single magnet can be left on and the opposite side of the fence moved forward or back for fine adjustments.

WARNING!
Do Not Operate Unless In Contact With Ferrous Target

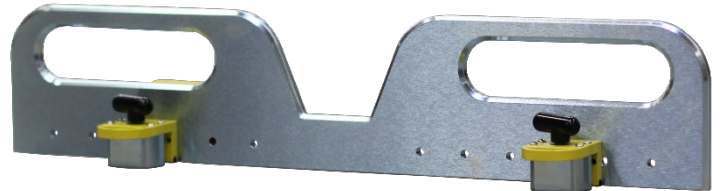

Specifications

Maximum Breakaway Force ^{1,2,4}	291.01 lbs	132 kg
Maximum Shear ^{1,2,4}	41.89 lbs	19 kg
Full Saturation Thickness	0.24 in	6 mm
Overall Height (Max)	4.29 in	109 mm
Overall Length	21 in	533.4 mm
Overall Width	2.72 in	69.15 mm
Net Weight	8.38 lbs	3.8 kg
Magnetic Pole Footprint	1.57 x 1.22 (2x) in	40 x 31 (2x) mm

Material Thickness - mm (in)	0.5 (0.02)	1.0 (0.04)	2.0 (0.08)	3.0 (0.12)	4.0 (0.16)	5.0 (0.20)	6.0 (0.24)	50.0 (1.97)
Maximum Force ⁴ - kg (lbs)	16.9 (37.32)	45.2 (99.65)	86.4 (190.48)	117.6 (259.26)	124.9 (275.42)	129.5 (285.56)	132.1 (291.16)	132.5 (292.05)

¹ Determined in laboratory environment on 2" thick SAE1018 Steel with surface roughness 63 micro inches. Many factors contribute to the actual breakaway force and safe working load in each application. Consult a Magswitch Applications Engineer and test the Magswitch in each application before deployment.

² All data applies to standard tool.

³ Determined with SAE1018 Steel L=200mm W=200mm.

⁴ Values may vary by +/- 5%.

⁵ Maximum forces listed above are not safe lifting forces. Designer must take into account safety factor when specifying tool. Magswitch recommends SWL = 5:1 for most applications.

Product Dimensions
